

## ▼ 3.6/01

### Silo Type 60

**Symmetrical stainless steel silo  
rounded body, edging calibrated, pressed cone,  
all seams butt-welded, smoothed and polished,  
patented stainless steel valve with clamp closing  
and hand lever  
clamping ring lid with filling tube**



- ▼ **5.1 Lid with filling tube**
  - formed sealing surface
  - for dust-free docking
- ▼ **7.5 Clamping ring**
  - airtight closing
  - sealable
  - exchangeable
- ▼ **7.8 Sealing**
  - in food grade quality
  - exchangeable
- ▼ **7.2 Cone**
  - flanged rim
  - smooth-walled
  - angle of repose 60°
  - use for easy flowing bulk material
- ▼ **7.6 Valve with hand lever Type MC**
  - dust-tight
  - continuously adjustable
  - sealable
  - easy to clean
  - easy to assemble
- ▼ **7.1 Outlet tube**
  - for dust-free docking
- ▼ **7.8 Accessories**
  - sight glass
  - handles
  - label-holders
- ▼ **6.2 Carriages**







## Silo Type 60

3.6/01 ▼

### Material :

All parts made of stainless steel AISI 304 or AISI 316L

Valve flanges and valve disk made of stainless steel AISI 316L

Clamp and hand lever made of stainless steel AISI 304

Sealing made of silicone food grade quality

### Surface :

all parts inside and outside polished and brushed to a 320 grit

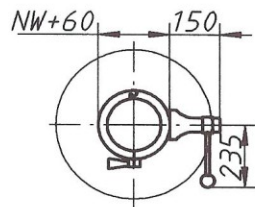
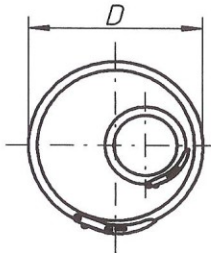
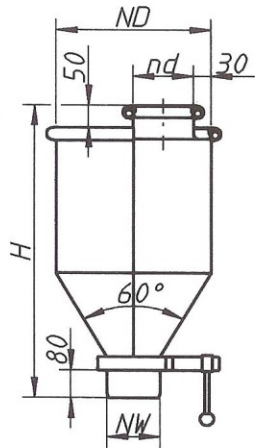

| NW  | H    | D    | nd  | s   | G   | V    | W | ART. NR. | ND   | L* |
|-----|------|------|-----|-----|-----|------|---|----------|------|----|
| 150 | 376  | 192  | -   | 1,2 | 9   | 5    | 1 | 0821100  | 170  |    |
| 150 | 376  | 192  | -   | 1,2 | 9   | 5    | 3 | 0821101  | 170  |    |
| 150 | 388  | 275  | -   | 1,2 | 11  | 10   | 1 | 0821102  | 250  |    |
| 150 | 388  | 275  | -   | 1,2 | 11  | 10   | 3 | 0821103  | 250  |    |
| 150 | 473  | 343  | -   | 1,2 | 12  | 20   | 1 | 0821104  | 315  | ○  |
| 150 | 473  | 343  | -   | 1,2 | 12  | 20   | 3 | 0821105  | 315  | ○  |
| 150 | 858  | 343  | -   | 1,2 | 16  | 50   | 1 | 0821106  | 315  |    |
| 150 | 858  | 343  | -   | 1,2 | 16  | 50   | 3 | 0821107  | 315  |    |
| 150 | 751  | 401  | 170 | 1,2 | 16  | 50   | 1 | 0821108  | 375  | ○  |
| 150 | 751  | 401  | 170 | 1,2 | 16  | 50   | 3 | 0821109  | 375  | ○  |
| 150 | 1203 | 401  | 170 | 1,2 | 21  | 100  | 1 | 0821110  | 375  |    |
| 150 | 1203 | 401  | 170 | 1,2 | 21  | 100  | 3 | 0821111  | 375  |    |
| 200 | 931  | 482  | 250 | 1,2 | 22  | 100  | 1 | 0821112  | 450  | ○  |
| 200 | 931  | 482  | 250 | 1,2 | 22  | 100  | 3 | 0821113  | 450  | ○  |
| 200 | 1246 | 482  | 250 | 1,2 | 27  | 150  | 1 | 0821114  | 450  |    |
| 200 | 1246 | 482  | 250 | 1,2 | 27  | 150  | 3 | 0821115  | 450  |    |
| 200 | 971  | 587  | 250 | 1,2 | 26  | 150  | 1 | 0821116  | 560  |    |
| 200 | 971  | 587  | 250 | 1,2 | 26  | 150  | 3 | 0821117  | 560  |    |
| 200 | 1174 | 587  | 250 | 1,2 | 29  | 200  | 1 | 0821118  | 560  | ○  |
| 200 | 1174 | 587  | 250 | 1,2 | 29  | 200  | 3 | 0821119  | 560  | ○  |
| 200 | 1091 | 629  | 250 | 1,5 | 34  | 200  | 1 | 0821120  | 600  |    |
| 200 | 1091 | 629  | 250 | 1,5 | 34  | 200  | 3 | 0821121  | 600  |    |
| 200 | 1445 | 629  | 250 | 1,5 | 42  | 300  | 1 | 0821122  | 600  | ○  |
| 200 | 1445 | 629  | 250 | 1,5 | 42  | 300  | 3 | 0821123  | 600  | ○  |
| 250 | 1165 | 745  | 315 | 1,5 | 43  | 300  | 1 | 0821124  | 710  |    |
| 250 | 1165 | 745  | 315 | 1,5 | 43  | 300  | 3 | 0821125  | 710  |    |
| 250 | 1417 | 745  | 315 | 1,5 | 49  | 400  | 1 | 0821126  | 710  | ○  |
| 250 | 1417 | 745  | 315 | 1,5 | 49  | 400  | 3 | 0821127  | 710  | ○  |
| 250 | 1452 | 839  | 315 | 2,0 | 69  | 500  | 1 | 0821128  | 800  |    |
| 250 | 1452 | 839  | 315 | 2,0 | 69  | 500  | 3 | 0821129  | 800  |    |
| 250 | 1651 | 839  | 315 | 2,0 | 77  | 600  | 1 | 0821130  | 800  | ○  |
| 250 | 1651 | 839  | 315 | 2,0 | 77  | 600  | 3 | 0821131  | 800  | ○  |
| 300 | 1498 | 1002 | 315 | 2,0 | 88  | 700  | 1 | 0821132  | 950  |    |
| 300 | 1498 | 1002 | 315 | 2,0 | 88  | 700  | 3 | 0821133  | 950  |    |
| 300 | 1639 | 1002 | 315 | 2,0 | 95  | 800  | 1 | 0821134  | 950  | ○  |
| 300 | 1639 | 1002 | 315 | 2,0 | 95  | 800  | 3 | 0821135  | 950  | ○  |
| 300 | 1535 | 1249 | 315 | 2,0 | 109 | 1000 | 1 | 0821136  | 1200 | ○  |
| 300 | 1535 | 1249 | 315 | 2,0 | 109 | 1000 | 3 | 0821137  | 1200 | ○  |
| 300 | 1712 | 1249 | 315 | 2,0 | 119 | 1200 | 1 | 0821138  | 1200 |    |
| 300 | 1712 | 1249 | 315 | 2,0 | 119 | 1200 | 3 | 0821139  | 1200 |    |

NW = nominal diameter outlet tube, H = silo height, D = outside diameter, nd = nominal diameter inlet tube, s = sheet thickness, G = weight in kg, V = volume in litres, W1 = stainless steel AISI 304, W3 = stainless steel AISI 316L, ND = nominal diameter silo, L● = available from stock, L○ = to be preferred