

### ▼ 3.7/03

## Cylindrical Pharma Container Type AS

Stainless steel pharma container with symmetrical outlet cone

Upper base and cone jointed over massive ring, all seams butt-welded, smoothed and polished, patented stainless steel valve with clamp closing and hand lever, upper base with ventilating tube

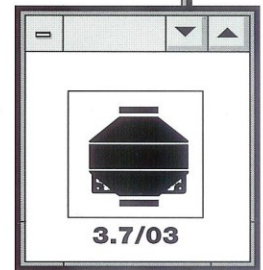

#### ▼ 7.4 Lid

- formed sealing surface
- exchangeable

#### ▼ 7.5 Clamping ring

- airtight closing
- sealable
- exchangeable

#### ▼ 7.8 Sealing

- in food grade quality
- exchangeable

#### ▼ 7.3 Upper base

- conical
- smooth-walled
- rim with edging

#### ▼ 7.2 Cone

- body smooth-walled
- asymmetrical angle of repose
- use for difficult flowing bulk material

#### ▼ 7.6 Valve with hand lever type MC

- dust-tight
- continuously adjustable
- sealable
- easy to clean
- easy to assemble

#### ▼ 7.1 Outlet tube

- for dust-free docking

#### ▼ 7.8 Accessories

- sight glass
- handles
- label-holders

#### ▼ 6.2 Carriages





## Cylindrical Pharma Container Type AS

3.7/03 ▼

### Material:

All parts made of stainless steel AISI 304 or AISI 316L

Valve flanges and valve disk made of stainless steel AISI 316L

Clamp and hand lever made of stainless steel AISI 304

Sealing made of silicone food grade quality

### Surface:

All parts inside and outside polished and brushed to a 320 grit

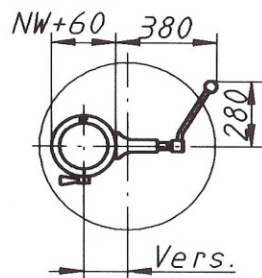
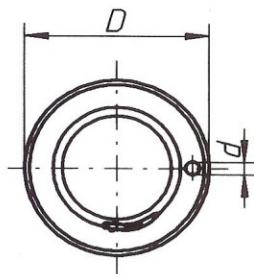
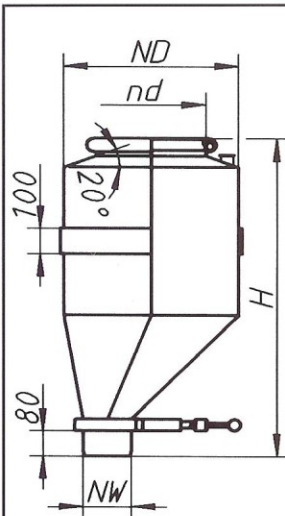

NW	H	D	d	nd	Vers.	s	G	V	W	ART. NR.	ND	L*
200	998	470	20	315	84,6	1,2	31	100	1	0101345	450	
200	998	470	20	315	84,6	1,2	31	100	3	0101346	450	
200	1313	470	20	315	84,6	1,2	36	150	1	0101347	450	
200	1313	470	20	315	84,6	1,2	36	150	3	0101348	450	
200	1041	580	32	375	125,0	1,2	37	150	1	0101349	560	
200	1041	580	32	375	125,0	1,2	37	150	3	0101350	560	
200	1244	580	32	375	125,0	1,2	40	200	1	0101351	560	
200	1244	580	32	375	125,0	1,2	40	200	3	0101352	560	
200	1157	620	32	450	139,8	1,5	49	200	1	0101353	600	
200	1157	620	32	450	139,8	1,5	49	200	3	0101354	600	
200	1511	620	32	450	139,8	1,5	56	300	1	0101355	600	
200	1511	620	32	450	139,8	1,5	56	300	3	0101356	600	
250	1230	730	32	560	161,8	1,5	60	300	1	0101357	710	
250	1230	730	32	560	161,8	1,5	60	300	3	0101358	710	
250	1482	730	32	560	161,8	1,5	67	400	1	0101359	710	
250	1482	730	32	560	161,8	1,5	67	400	3	0101360	710	
250	1521	830	50	600	194,9	2,0	99	500	1	0101361	800	
250	1521	830	50	600	194,9	2,0	99	500	3	0101362	800	
250	1720	830	50	600	194,9	2,0	106	600	1	0101363	800	
250	1720	830	50	600	194,9	2,0	106	600	3	0101364	800	
300	1578	830	50	600	231,7	2,0	123	700	1	0101365	950	
300	1578	830	50	600	231,7	2,0	123	700	3	0101366	950	
300	1719	830	50	600	231,7	2,0	130	800	1	0101367	950	
300	1719	830	50	600	231,7	2,0	130	800	3	0101368	950	
300	1641	830	50	600	323,6	2,0	152	1000	1	0101369	1200	
300	1641	830	50	600	323,6	2,0	152	1000	3	0101370	1200	
300	1818	830	50	600	323,6	2,0	163	1200	1	0101371	1200	
300	1818	830	50	600	323,6	2,0	163	1200	3	0101372	1200	

NW = nominal diameter outlet tube, H = container height, D = outside diameter, d = nominal diameter ventilating tube, nd = nominal diameter inlet tube, Vers. = offset, s = sheet thickness, G = weight in kg, V = volume in litres, W1 = stainless steel AISI 304, W3 = stainless steel AISI 316L, ND = nominal diameter container, L ● = available from stock, L ○ = to be preferred

Müller GmbH  
P.O.Box 1409  
D-79604 Rheinfelden

Phone (+49) 76 23-9 69-0  
Fax (+49) 76 23-9 69-69  
<http://www.mueller-gmbh.com>



Quality management  
ISO 9001/EN 29001

A Division of the  
**MÜLLER** Group